

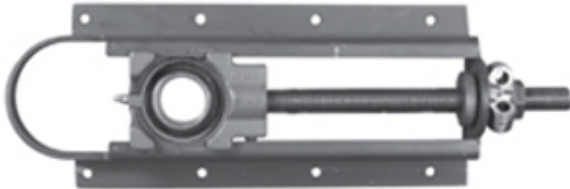

LINK BELT TAS3U224N9 Take Up Unit Bearings



Bearing No. TAS3U224N9

TAS3U224N9 Bearing 2D drawings and 3D CAD models

Category	Take Up Unit Bearings
Inventory	0.0
Manufacturer Name	REXNORD
Minimum Buy Quantity	N/A
Weight	9.97
EAN	0662327141363
Product Group	M06110
Component Description	Take Up Unit with Frame
Rolling Element	Ball Bearing
Housing Style	Center Pull Horizontal
Mounting Method	Set Screw
Compatible Take Up Frame	TAS
Adjustment Travel Length	9
Insert Part Number	UG224NL
Housing Material	Cast Iron
Other Features	Single Row Spherical Standard Duty Wide Inner Race Light Duty Conveyor Type Formed Steel Frame One Lip Seal
Inch - Metric	Inch
Long Description	Take Up Unit with Frame; 1-1/2" Bore; Ball Bearing; Center Pull Horizontal; Set Screw Mount; TAS Take Up Frame; 9 Adjustment Travel; UG224NL Insert Part; Cast Iron Housing Material



NTN BEARING MANUFACTURING DE MEXICO,S...

Category	Take Up Units
UNSPSC	31171533
Harmonized Tariff Code	8483.20.40.40
Noun	Bearing
Keyword String	Take Up
Manufacturer URL	http://www.rexnord.com
Manufacturer Internal Number	5814136
Weight / LBS	21.96
d	1.5 Inch 38.1 Millimeter
Slot to Slot Distance	0 Inch 0 Millimeter
Slot Width	0 Inch 0 Millimeter